

DEORE XT Crankset

**FC-M8120-1 FC-M8120-B2**  
**BB-MT800 SM-CRM85**

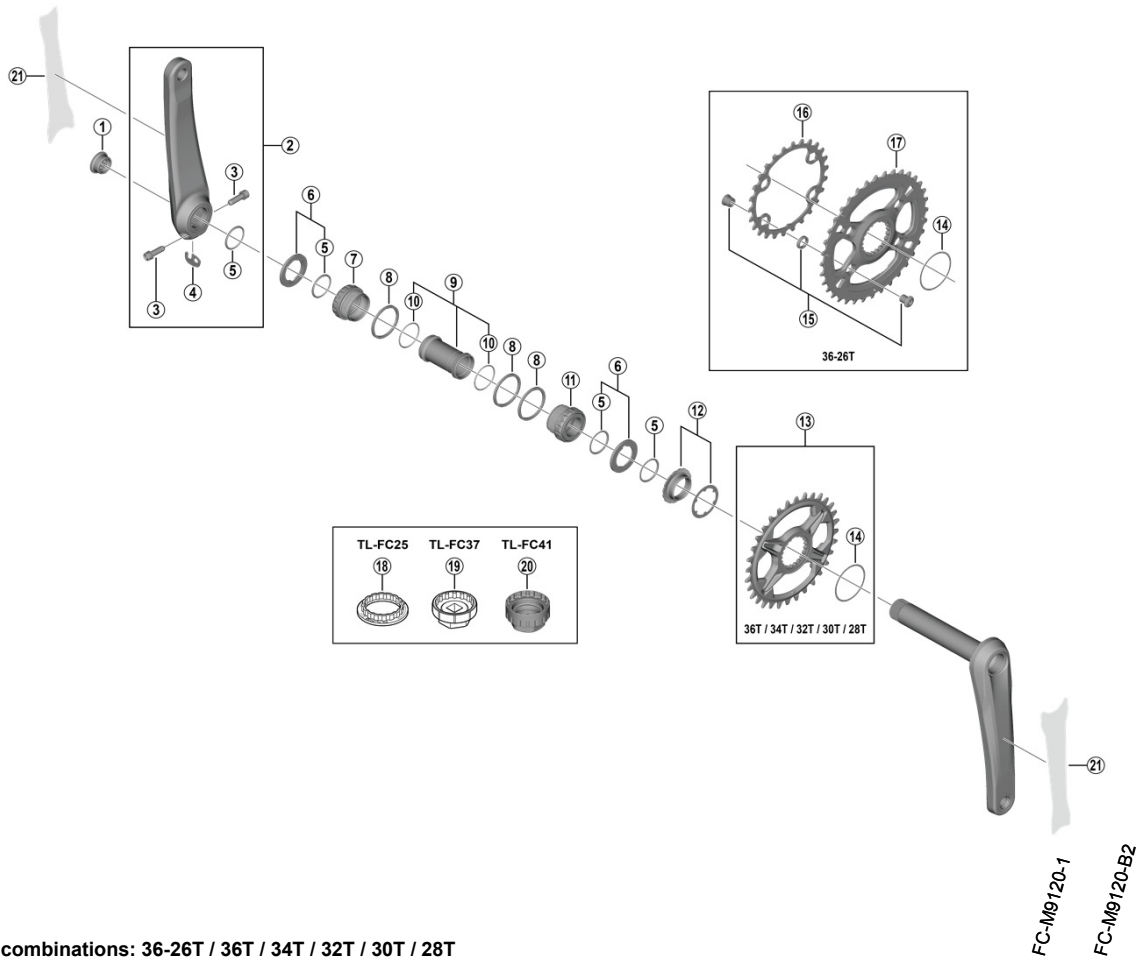

• Chaining teeth combinations: 36-26T / 36T / 34T / 32T / 30T / 28T

ITEM NO.	SHIMANO CODE NO.	DESCRIPTION	INTERCHANGEABILITY	
1	Y0J620000	Crank Arm Fixing Screw		
2	Y0J698010	Left Hand Crank Arm Unit 165 mm		
	Y0J698020	Left Hand Crank Arm Unit 170 mm		
	Y0J698030	Left Hand Crank Arm Unit 175 mm		
	Y0J698040	Left Hand Crank Arm Unit 180 mm		
3	Y1GS21000	Clamp Screw with Washer (M6 x 21)		
4	Y0J698050	Plate		
5	Y1F316000	Ring	A	A
6	Y1PW98070	Spacer & Ring	A	A
7	Y1V698010	Left Hand Adapter (B.C.1.37" x 24T) English Thread (BB-MT800)		
8	Y1P804000	Spacer (2.5 mm)		
9	Y1E598210	Inner Cover & O-Ring		
10	Y1TF21000	O-Ring		
11	Y1V698020	Right Hand Adapter (B.C.1.37" x 24T) English Thread (BB-MT800)		
12	Y0J698060	Lock Ring & Washer		
13	ISMCRM85Z8	Chainring 28T w/Spacer (SM-CRM85)		
	ISMCRM85A0	Chainring 30T w/Spacer (SM-CRM85)		
	ISMCRM85A2	Chainring 32T w/Spacer (SM-CRM85)		
	ISMCRM85A4	Chainring 34T w/Spacer (SM-CRM85)		
	ISMCRM85A6	Chainring 36T w/Spacer (SM-CRM85)		
14	Y0JC61000	Spacer		
* 15	Y0J898020	Gear Fixing Bolt Unit (4 sets)		
* 16	Y0JB26000	Chainring 26T-BJ for 36-26T		
17	Y0J898010	Chainring 36T-BJ for 36-26T		
18	Y13009260	TL-FC25 Adapter Installation Tool		
19	Y13009270	TL-FC37 Adapter Installation Tool		
20	Y13098720	TL-FC41 Front Chaining Direct Mount Tool		
* 21	Y0J898070	Protection Sticker for Crank Arm 165/170 mm (2 pcs.)		
* 21	Y0J898080	Protection Sticker for Crank Arm 175/180 mm (2 pcs.)		

A: Same parts.

B: Parts are usable, but differ in materials, appearance, finish, size, etc.

Absence of mark indicates non-interchangeability.

Specifications are subject to change without notice.

Nov.-2019-4558A

© Shimano Inc. I

**SHIMANO**