

Shifting Lever (2-WAY RELEASE)



User's manuals in other languages are available at :
<http://si.shimano.com>

IMPORTANT NOTICE

- Contact the place of purchase or a bicycle dealer for information on installation and adjustment of the products which are not found in the user's manual. A dealer's manual for professional and experienced bicycle mechanics is available on our website (<http://si.shimano.com>).
- Do not disassemble or alter this product.

For safety, be sure to read this user's manual thoroughly before use, and follow them for correct use.

Important Safety Information

Guidelines that require replacement, contact the place of purchase or a bicycle dealer.

⚠ WARNING

- After reading the user's manual carefully, keep it in a safe place for later reference.

Note

- Be sure to keep turning the crank during the lever operation.
- Products are not guaranteed against natural wear and deterioration from normal use and aging.
- For maximum performance we highly recommend Shimano lubricants and maintenance products.

Regular inspections before riding the bicycle

Before riding the bicycle, check the following items. If any problems are found with the following items, contact the place of purchase or a bicycle dealer.

- Is gear shifting carried out smoothly?
- Are the levers securely installed to the handlebar?
- Do any abnormal noises occur during operation?

Names of parts

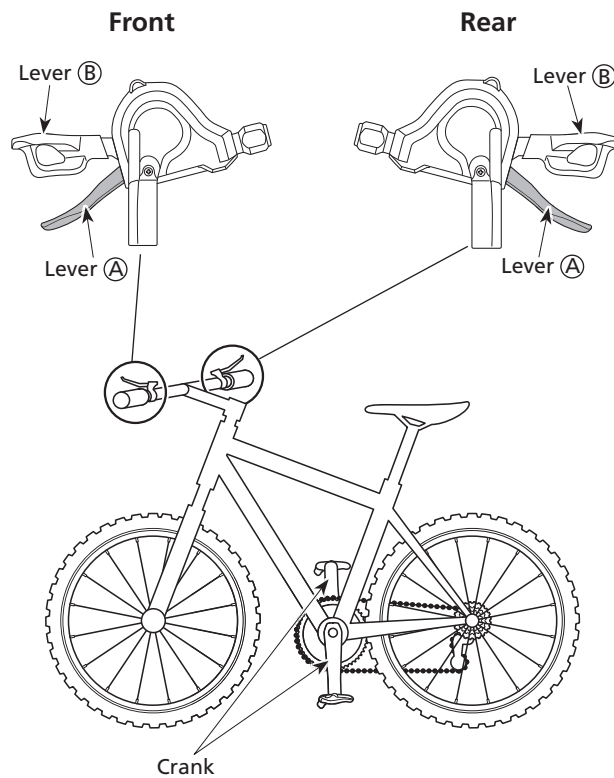

Operation

Gear shifting operation

Be sure to keep turning the crank during the lever operation.

Caution on operation

Both lever (A) and (B) always return to the start position after shifting.

Operation of rear derailleur lever

You can vary the lever stroke to shift the desired number of gears, so that to shift by one gear only, move the lever to the ① position, and to shift by two gears at one time, move the lever to the ② position.

- Lever (A) : Shifts from smaller to larger rear sprocket.

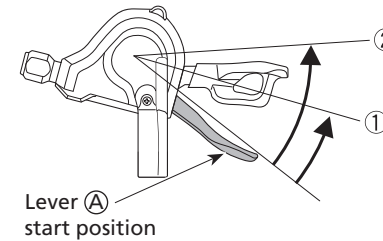

- ① : Shifts one sprocket
E.x. : from 3rd to 4th

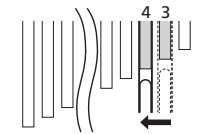

- ② : Quick-shifts two sprockets
E.x. : from 3rd to 5th

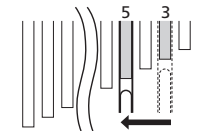

- Lever (B) : Shifts from larger to smaller rear sprocket.

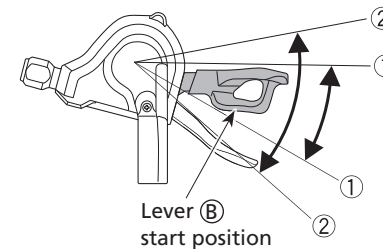

"You can shift gears either by pushing or pulling the lever."
Some models allow two-step gear shifting.

E.x. : from 4th to 3rd

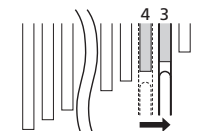

Operation of front derailleur levers

- Lever (A) : Shifts from smaller to larger front chainring.

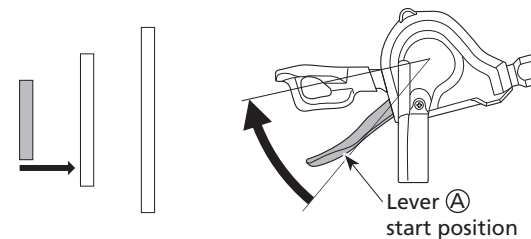

- Lever (B) : Shifts from larger to smaller front chainring.

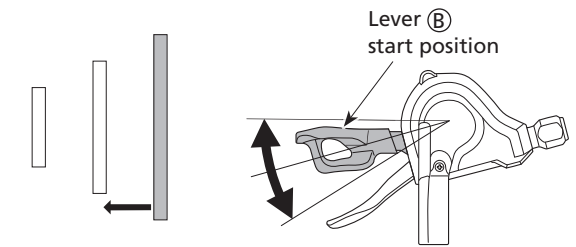

"You can shift gears either by pushing or pulling the lever."

SHIMANO

SHIMANO AMERICAN CORPORATION
One Holland, Irvine, California 92618, U.S.A. Phone: +1-949-951-5003

SHIMANO EUROPE B.V.
Industrieweg 24, 8071 CT Nunspeet, The Netherlands Phone: +31-341-272222

SHIMANO INC.
3-77 Oimatsu-cho, Sakai-ku, Sakai-shi, Osaka 590-8577, Japan

Please note: specifications are subject to change for improvement without notice.
(English)

© Jun. 2014 by Shimano Inc. HTR