

Rear Wheel (8/9/10/MTB 11-speed)  
**WH-MT500-CL-R12-B-29**

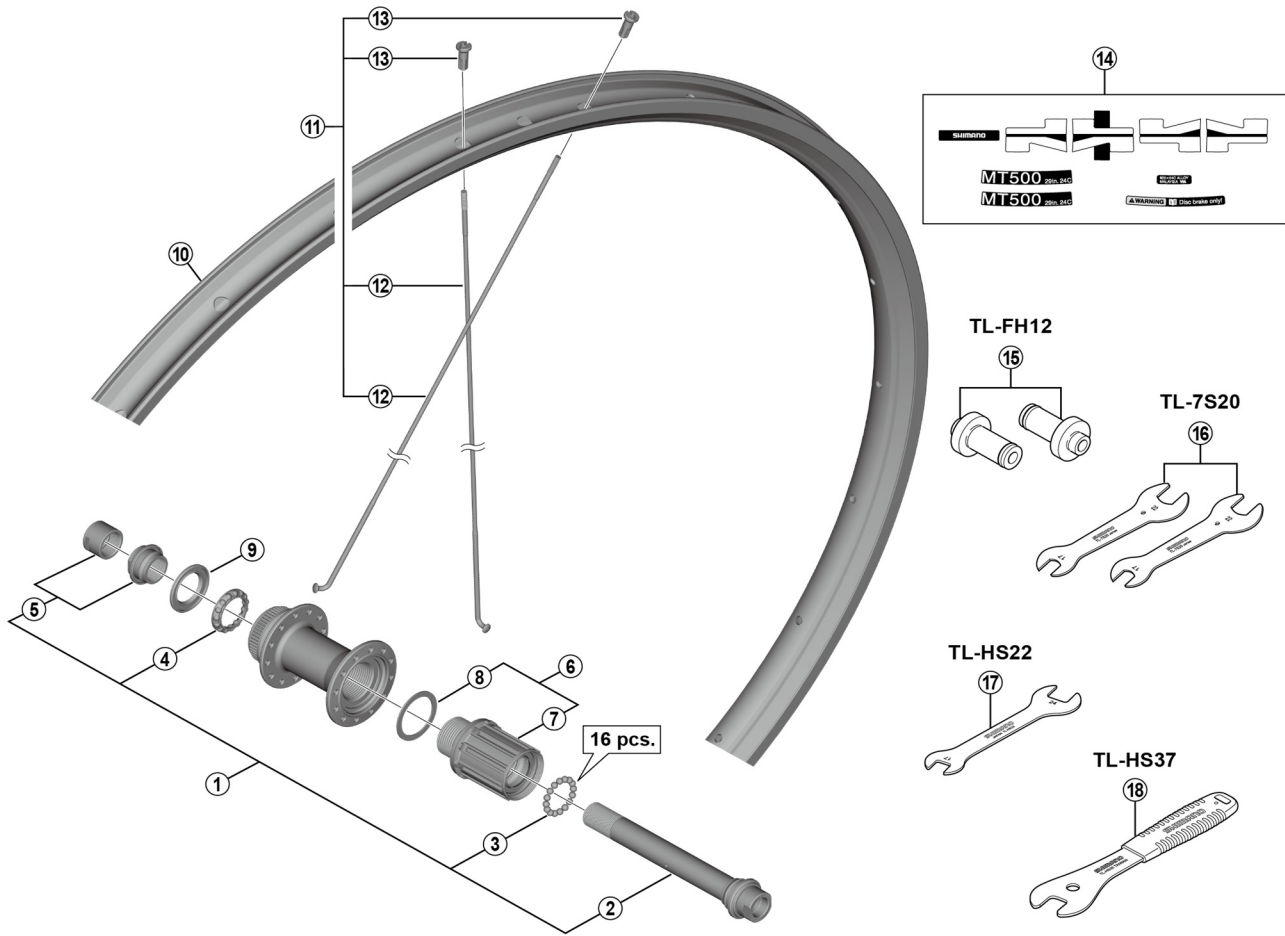

• Over Lock Nut Dimension: 148 mm (5-13/16")

ITEM NO.	SHIMANO CODE NO.	DESCRIPTION	INTERCHANGEABILITY		
1	Y0EY98010	Complete Hub Axle			
2	Y0EY98020	Hub Axle Unit			
3	Y4FE98030	Steel Ball (5/32") 34 pcs.	A	A	A
4	Y0CJ98030	Ball Retainer (5/32")	A	A	A
5	Y0CK98030	Left Hand Lock Nut & Cone w/Dust Cover			
6	Y0ES98030	Complete Freewheel Body			
7	Y0ES98040	Freewheel Body Unit			
8	Y3CZ12000	Freewheel Body Washer	A	A	A
9	Y26D10000	Seal Ring	A	A	A
10	-	Rim (24H)			
11	-	Spoke Unit {Spoke (290 mm x 24 pcs.) / Nipple (24 pcs.)}			
12	Y0ERS2000	Spoke (290 mm)			
13	Y012Y3352	Nipple			
14	Y0ER98010	Rim Sticker Unit			
15	Y13098011	TL-FH12 Hub Setting Tool for 12 mm Thru-axle	A	A	A
16	Y13098900	TL-7S20 Hub Spanner (17 mm x 22 mm) 2 pcs.	A	A	A
17	Y3C227000	TL-HS22 Hub Spanner (17 mm x 24 mm)	A	A	A
18	Y23098030	TL-HS37 Hub Spanner 17 mm	A	A	A

A: Same parts.

B: Parts are usable, but differ in materials, appearance, finish, size, etc.

Absence of mark indicates non-interchangeability.

Specifications are subject to change without notice.

WH-MT15-A-CL-R12-29

WH-MT35-CL-R12-29

WH-M8020-TL-R12-29

Dec.-2017-4322

© Shimano Inc. I

**SHIMANO**