

Rear Wheel (8/9/10/MTB 11-speed)
WH-MT500-CL-R12-29

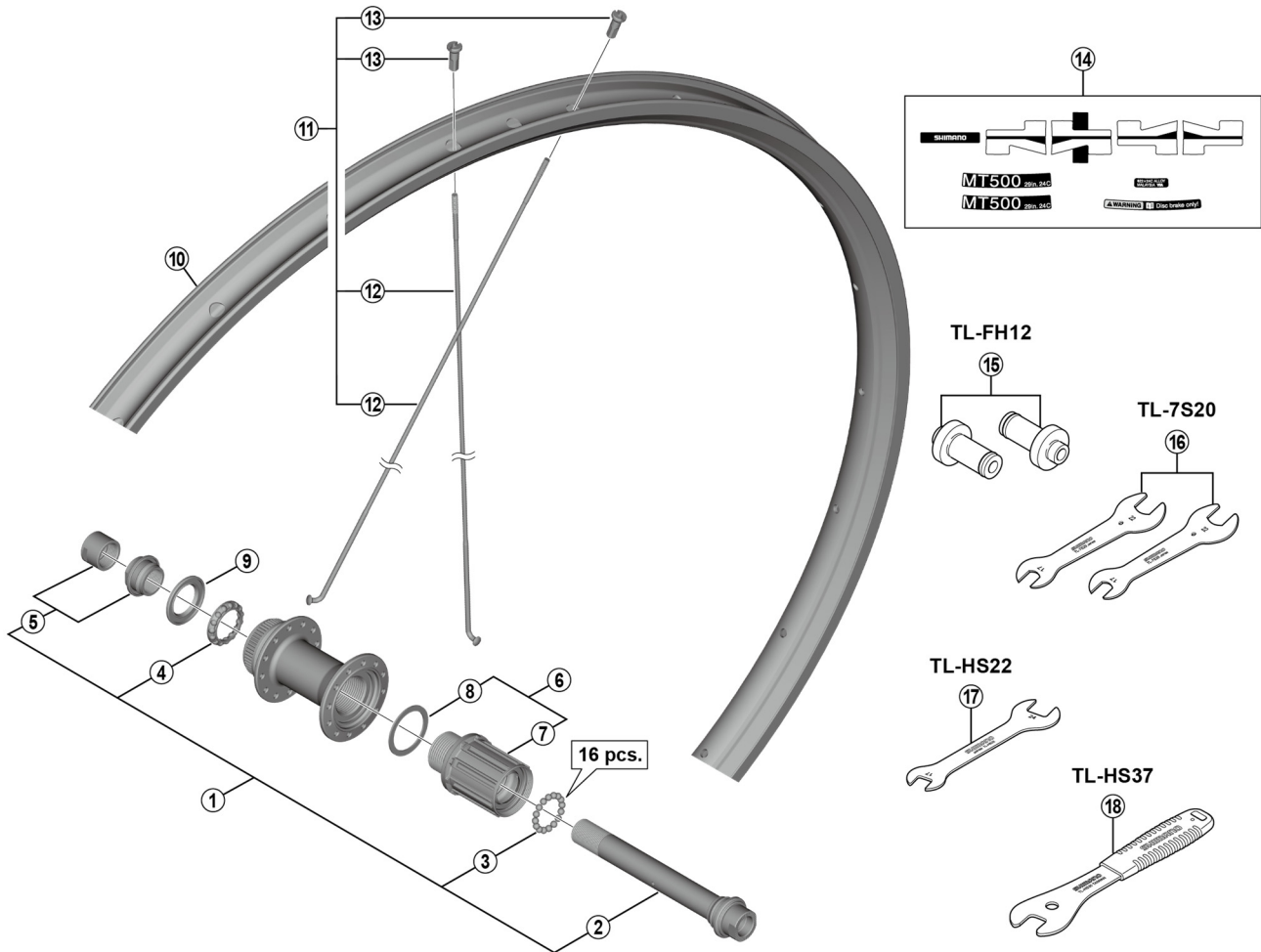

• Over Lock Nut Dimension: 142 mm (5-19/32")

ITEM NO.	SHIMANO CODE NO.	DESCRIPTION	INTERCHANGEABILITY	
1	Y0ES98010	Complete Hub Axle		
2	Y0ES98020	Hub Axle Unit		
3	Y4FE98030	Steel Ball (5/32") 34 pcs.		A
4	Y0CJ98030	Ball Retainer (5/32")		A
5	Y0CK98030	Left Hand Lock Nut & Cone w/Dust Cover		A
6	Y0ES98030	Complete Freewheel Body		
7	Y0ES98040	Freewheel Body Unit		
8	Y3CZ12000	Freewheel Body Washer	A	A
9	Y26D10000	Seal Ring	A	A
10	-	Rim {24H}		
11	-	Spoke Unit {Spoke (290 mm x 24 pcs.) / Nipple (24 pcs.)}		
12	Y0ERS2000	Spoke (290 mm)		
13	Y012Y3352	Nipple		
14	Y0ER98010	Rim Sticker Unit		
15	Y13098011	TL-FH12 Hub Setting Tool for 12 mm Thru-axle	A	A
16	Y13098900	TL-7S20 Hub Spanner (17 mm x 22 mm) 2 pcs.	A	A
17	Y3C227000	TL-HS22 Hub Spanner (17 mm x 24 mm)	A	A
18	Y23098030	TL-HS37 Hub Spanner 17 mm	A	A

A: Same parts.

B: Parts are usable, but differ in materials, appearance, finish, size, etc.

Absence of mark indicates non-interchangeability.

Specifications are subject to change without notice.

WH-M8000-TL-R12-29

WH-RS170-CL-R12

Nov.-2017-4320

© Shimano Inc. I

SHIMANO