

DISC BRAKE MOUNT ADAPTER

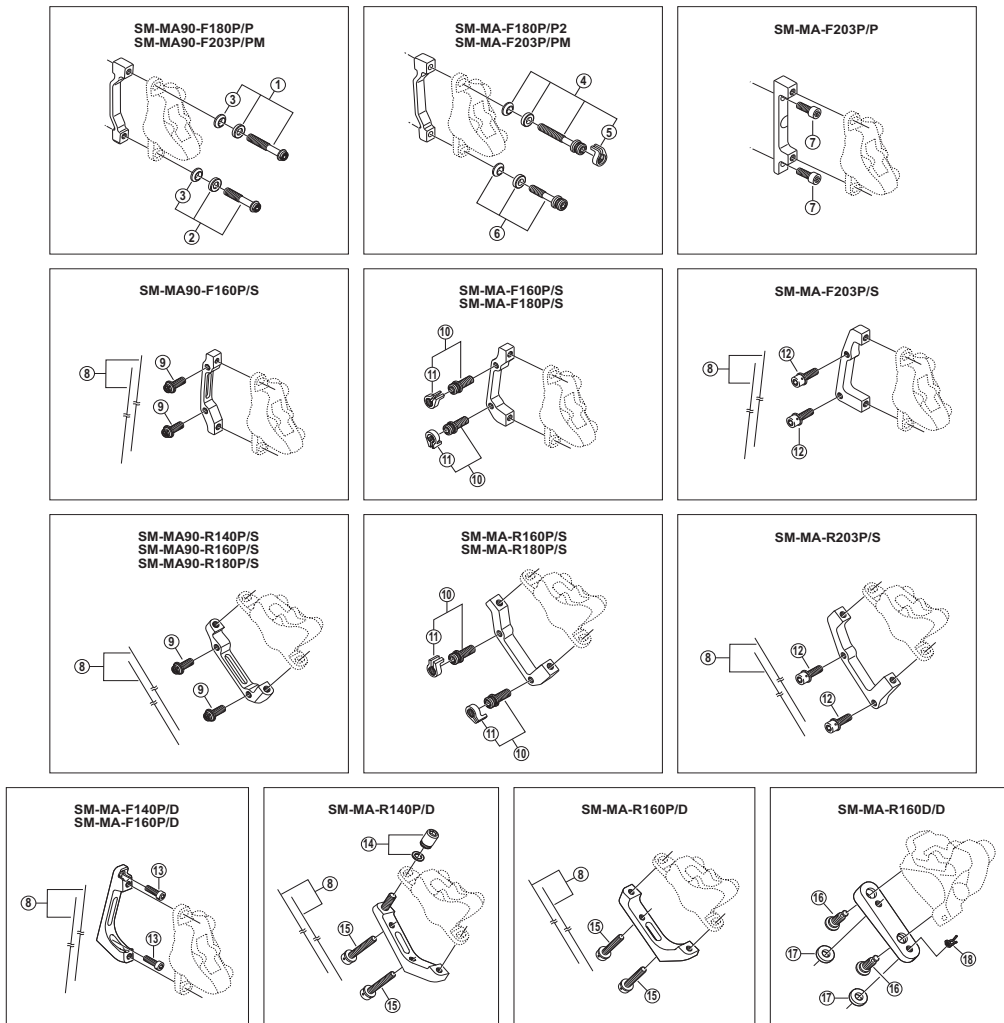

ITEM NO.	SHIMANO CODE NO.	DESCRIPTION
1	Y8LF98040	Caliper Fixing Bolt Unit (M6×36.3) for SM-MA90-F180P/P
	Y8JB98010	Caliper Fixing Bolt Unit (M6×38.6) for SM-MA90-F203P/PM
2	Y8LF98050	Caliper Fixing Bolt Unit (M6×30.5) for SM-MA90-F180P/P
	Y8JB98020	Caliper Fixing Bolt Unit (M6×32.8) for SM-MA90-F203P/PM
3	Y8LF12000	R-Washer A
4	Y8G498020	Caliper Fixing Bolt Unit (M6 x 37.9) for SM-MA-F180P/P2
	Y8J498010	Caliper Fixing Bolt Unit (M6 x 40.2) for SM-MA-F203P/PM
5	Y81703000	Snap Ring
6	Y8G498030	Caliper Fixing Bolt Unit (M6 x 32.1) for SM-MA-F180P/P2
	Y8J498020	Caliper Fixing Bolt Unit (M6 x 34.4) for SM-MA-F203P/PM
7	Y8B232310	Caliper Fixing Bolt (M6 x 15)
8	Y8B298010	Wire (2 pcs.)
9	Y8J721000	Caliper Fixing Bolt (M6 x 15.2)
10	Y8DS98010	Caliper Fixing Bolt (M6 x 18.7) & Snap Ring
11	Y8C511000	Snap Ring
12	Y8B512000	Caliper Fixing Bolt (M6 x 19)
13	Y81741100	Converter Fixing Bolt (M5 x 14)
14	Y81798020	Caliper Fixing Nut & Washer
	Y81743100	Converter Fixing Bolt (M5 x 16.8) for 10 mm Rear mount thickness
	Y81743150	Converter Fixing Bolt (M5 x 21.8) for 15 mm Rear mount thickness
	Y81743200	Converter Fixing Bolt (M5 x 26.8) for 20 mm Rear mount thickness
	Y81743250	Converter Fixing Bolt (M5 x 31.8) for 25 mm Rear mount thickness
	Y81743300	Converter Fixing Bolt (M5 x 36.8) for 30 mm Rear mount thickness
15	Y81743350	Converter Fixing Bolt (M5 x 41.8) for 35 mm Rear mount thickness
16	Y8N206000	Caliper Fixing Bolt B
17	Y8NU02000	Washer
18	Y8NU03000	Snap Retainer

Jun.-2016-5155

© Shimano Inc. I

Specifications are subject to change without notice.

SHIMANO