

# DURA-ACE Front Chainwheel FC-9000

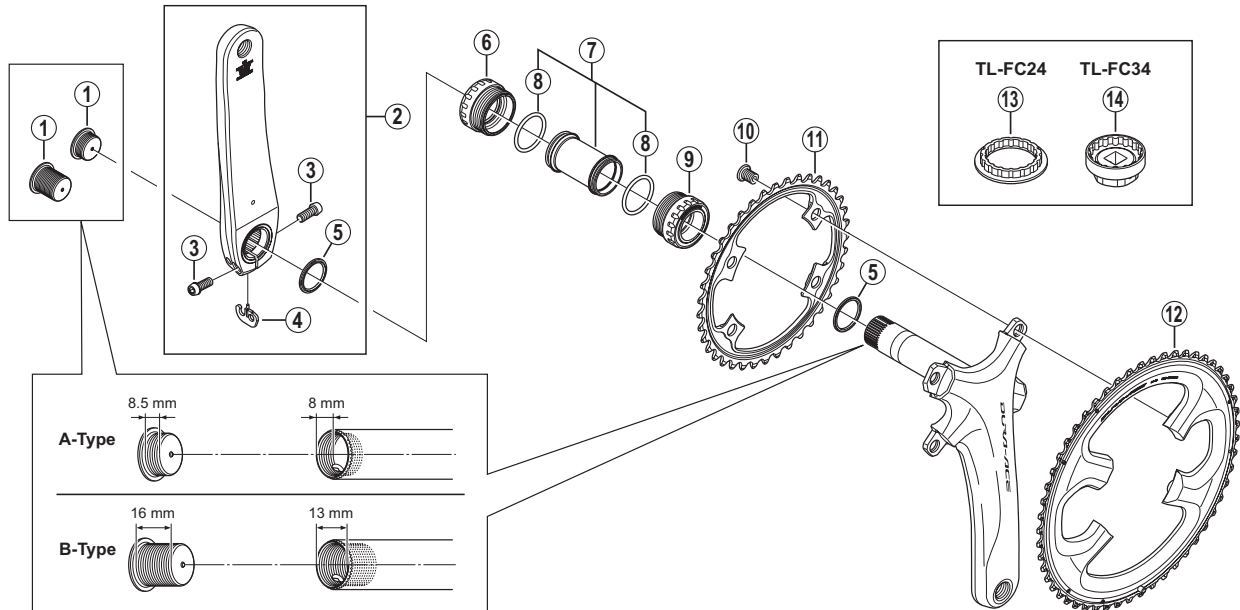

- Chaining teeth combinations: 50-34T/52-36T/52-38T/53-39T/54-42T/55-42T
- Bolt circle diameter: 110 mm

FC-6800  
FC-6700  
FC-7900

ITEM NO.	SHIMANO CODE NO.	DESCRIPTION	INTERCHANGEABILITY		
* 1	Y1KY08000	Crank Arm Fixing Bolt (A-Type: 8.5 mm)		B	A
	Y1N218000	Crank Arm Fixing Bolt (B-Type: 16 mm)		B	
2	Y1N298010	Left Hand Crank Arm 165 mm	B	B	B
	Y1N298020	Left Hand Crank Arm 167.5 mm			B
	Y1N298030	Left Hand Crank Arm 170 mm	B	B	B
	Y1N298040	Left Hand Crank Arm 172.5 mm	B	B	B
	Y1N298050	Left Hand Crank Arm 175 mm	B	B	B
	Y1N298060	Left Hand Crank Arm 177.5 mm			B
	Y1N298070	Left Hand Crank Arm 180 mm			B
3	Y1E512100	Clamp Bolt (M6 x 15)			A
4	Y1N298100	Plate	B	B	B
5	Y1F316000	Ring	A	A	A
6	Y1N398010	Left Hand Adapter (B.C.1.37" x 24T) English Thread (SM-BB9000)	B	B	B
	Y1N398020	Left Hand Adapter (M36 x 24T) Italian Thread (SM-BB9000)	B	B	B
7	Y1KY98130	Inner Cover & O-Ring	B	B	A
8	Y1TF21000	O-Ring	A	A	A
9	Y1N398030	Right Hand Adapter (B.C.1.37" x 24T) English Thread (SM-BB9000)	B	B	B
	Y1N398040	Right Hand Adapter (M36 x 24T) Italian Thread (SM-BB9000)	B	B	B
10	Y1H598160	Gear Fixing Bolt (M8 x 10.1 / 4 pcs.)	A		
11	Y1N234000	Chainring 34T-MA for 50-34T		B	
	Y1N236000	Chainring 36T-MB for 52-36T		B	
	Y1N238000	Chainring 38T-MC for 52-38T			
	Y1N239000	Chainring 39T-MD for 53-39T			B
	Y1N242000	Chainring 42T-ME for 54-42T/55-42T			
	Y1N298080	Chainring 50T-MA for 50-34T		B	
12	Y1N298110	Chainring 52T-MB for 52-36T		B	
	Y1N298120	Chainring 52T-MC for 52-38T			
	Y1N298090	Chainring 53T-MD for 53-39T		B	
	Y1N298130	Chainring 54T-ME for 54-42T			
	Y1N298140	Chainring 55T-ME for 55-42T			
13	Y13009240	TL-FC24 Adapter Installation Tool			
14	Y13009250	TL-FC34 Adapter Installation Tool			

A: Same parts.

B: Parts are usable, but differ in materials, appearance, finish, size, etc.

Absence of mark indicates non-interchangeability.

Jun.-2013-3325B

© Shimano Inc. I

Specifications are subject to change without notice.

# SHIMANO