

# ULTEGRA SPD-SL Pedals

## PD-R8000 (Standard / 4mm Longer Axle)

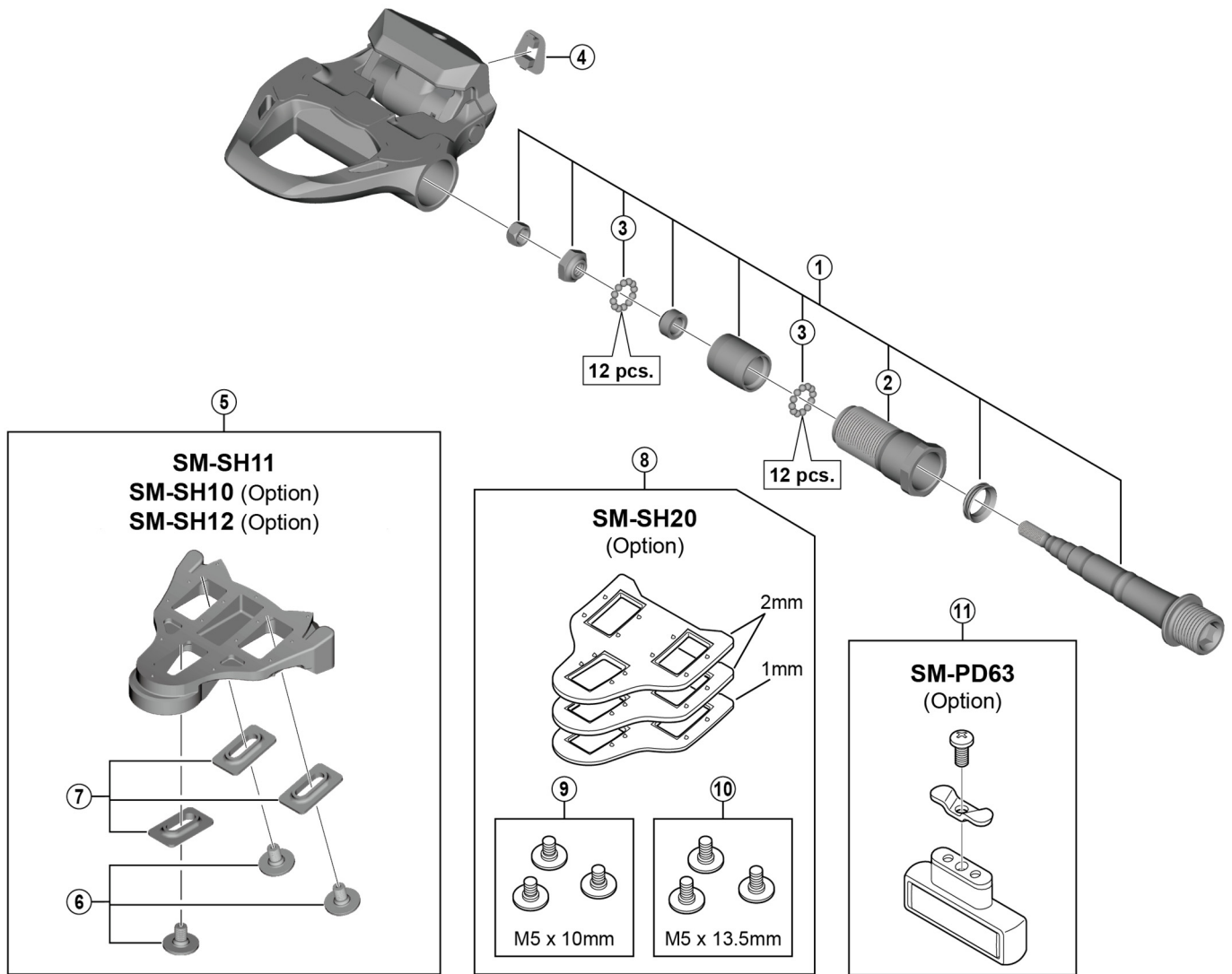

ITEM NO.	SHIMANO CODE NO.	DESCRIPTION	INTERCHANGEABILITY	
			PD-6800	PD-R9100
1	YL8B98010	Pedal Axle Assembly (Right / B.C.9/16" x 20T.P.I.)	A	
	YL8B98020	Pedal Axle Assembly (Right / B.C.9/16" x 20T.P.I.) for 4mm Long Type	A	
	YL8B98030	Pedal Axle Assembly (Left / B.C.9/16" x 20T.P.I.)	A	
	YL8B98040	Pedal Axle Assembly (Left / B.C.9/16" x 20T.P.I.) for 4mm Long Type	A	
2	YL8B98050	Lock Bolt (Right)	A	
	YL8B98060	Lock Bolt (Left)	A	
3	Y41N98030	Steel Ball (3/32") 62 pcs.	A	A
4	Y42U10300	Indicator	A	A
5	Y42U98010	SM-SH11 Cleat Set (Self-aligning mode / Pair / M5 x 8 mm)	A	A
	Y42U98020	SM-SH10 Cleat Set (Fixed mode / Pair / Option / M5 x 8 mm)	A	A
	Y40B98140	SM-SH12 Cleat Set (Front Center Pivot / Pair / Option / M5 x 8 mm)	A	A
6	Y42U98080	Cleat Fixing Bolt (M5 x 8 mm / 6 pcs.)	A	A
7	YL8898060	Cleat Washer (Silver / 6 pcs.)	A	A
8	Y40B98150	SM-SH20 Cleat Spacer Set (Option)	A	A
9	Y42U98070	Cleat Fixing Bolt (M5 x 10 mm) 6 pcs.	A	A
10	Y42U98060	Cleat Fixing Bolt (M5 x 13.5 mm) 6 pcs.	A	A
11	Y46J98010	SM-PD63 Reflector Unit (Pair/Option)	A	A
	Y46J98020	SM-PD63 Reflector Unit (AS/Pair/Option)	A	A

A: Same parts.

B: Parts are usable, but differ in materials, appearance, finish, size, etc.

Absence of mark indicates non-interchangeability.

Specifications are subject to change without notice.

Jun.-2017-4232

© Shimano Inc. I

# SHIMANO