

Thule 4670

> Instructions

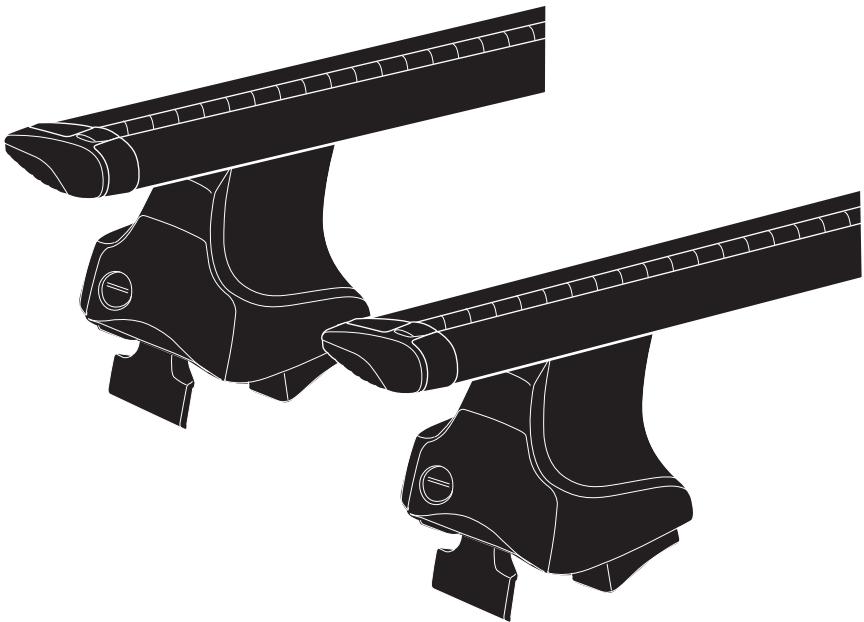

ISO 11154-E

46700

c.20140912
501-7527-03

Bring your life
thule.com

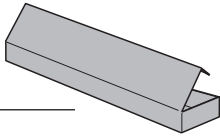

x4
 x2
 x4
 x4
 x4
 x1

596 x 2
 597 x 2
 163 x 1
 164 x 1
 165 x 1
 166 x 1

50993
 x 2
 50480
 x 2
 x 1
 x 1

1

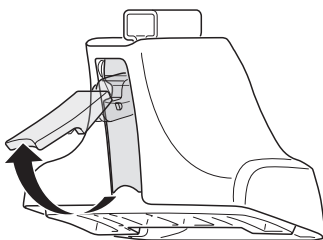
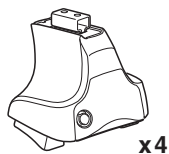

2

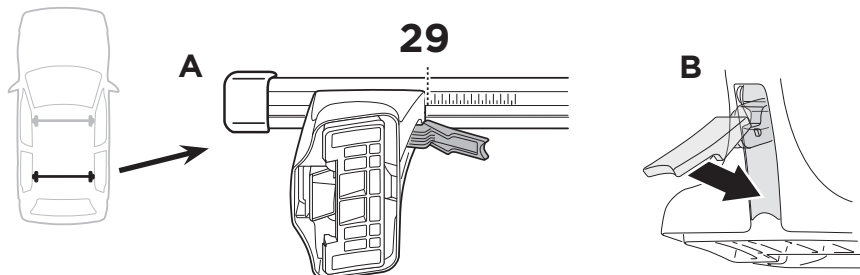
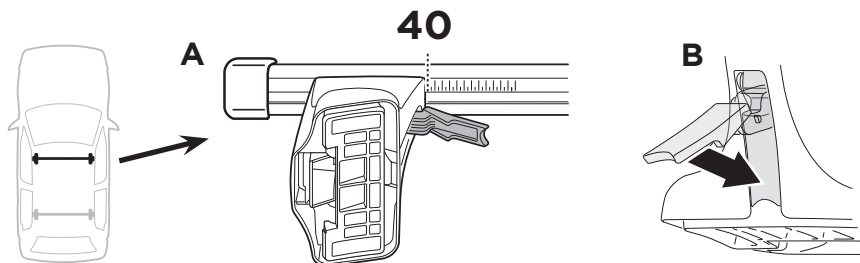
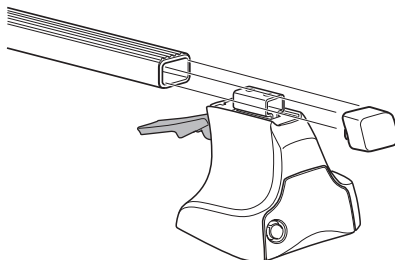
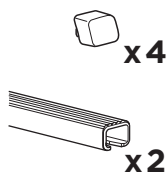

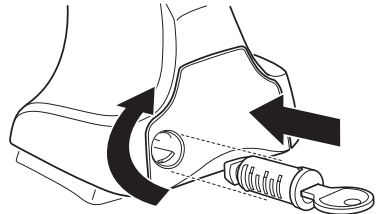
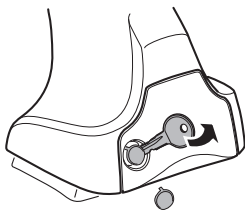
3**4**

VOLKSWAGEN Golf V, 3-dr Hatchback, 04-07
VOLKSWAGEN Golf V, 5-dr Hatchback, 04-07
VOLKSWAGEN Golf VI, 3-dr Hatchback, 08-
VOLKSWAGEN Golf VI, 5-dr Hatchback, 08-

164



596



163



596



166



597



165



597

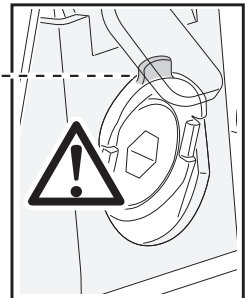
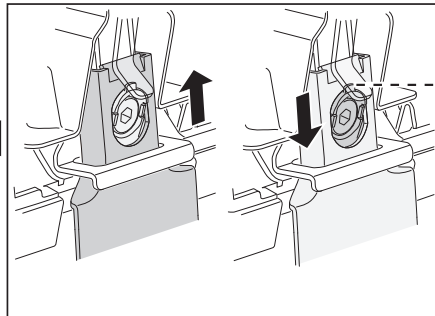
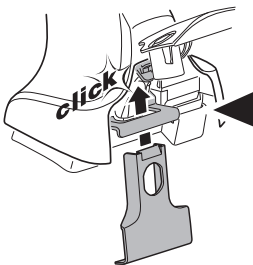
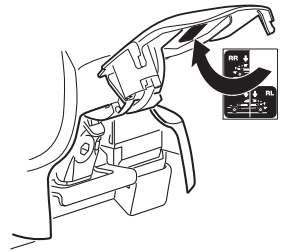
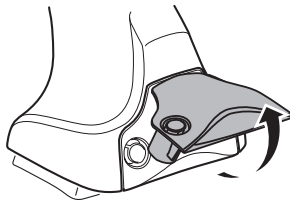
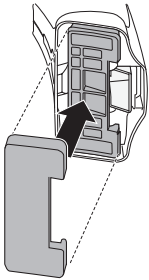

5

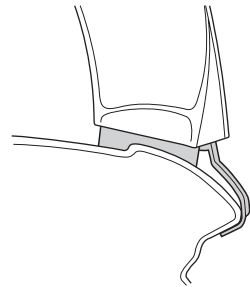
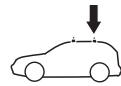
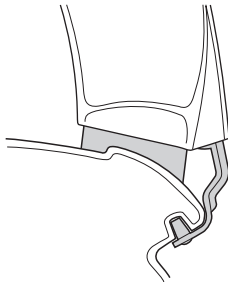
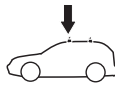
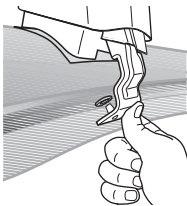
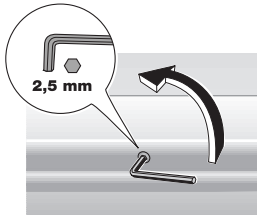
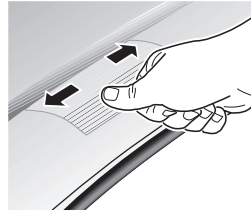
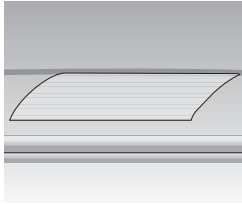
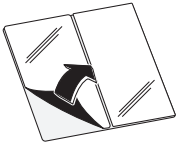
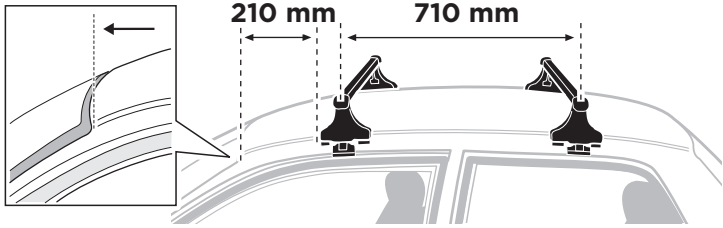
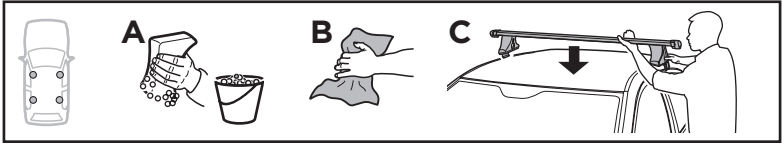

6

- EN** Tighten alternately
DE Die Schrauben abwechselnd anziehen
FR Serrer alternativement chaque côté
NL Afwisselend aan de linker- en de rechterkant aandraaien
IT Alternare il serraggio delle viti
ES Apretar alternativamente
PT Aperte alternadamente
SV Dra åt växelvis
DK Spænd skiftevis
NO Trekk til vekselvis
FI Kierrä vuorotellen
ET Pinguldage vaheldumisi
LV Pievelciēt pamišus
LT Užsukinėkite pakaitomis
PL Śruby dokręcaj naprzemiennie
RU Затягивайте попеременно
UK Затягти почергово
BG Затегнете последователно
CS Pokręřta багаřnika dokręřaj dokręřaj naprzemiennie.
SK Dotahujte striedavo

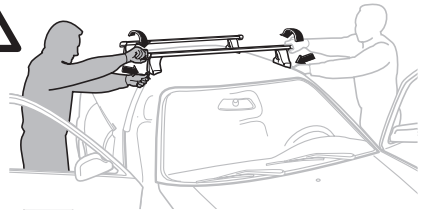

- SL** Privijajte izmenično
HR/BiH Naizmjenično zategnite
RO Strângeți alternativ
HU Egymástól függetlenül szorítandó
EL Σφιγγετε εναλλάξ
TR Dönüşümlü sıkın

- ZH** 交替拧紧
JA 自動固定
KO 번갈아 조이기
TH ชั่งนั้ในแบบสลับ

إحكام الربط بالتناوب
 חזק לסירוגין

AR
HE

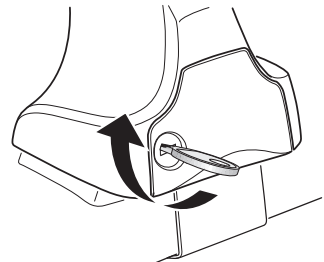
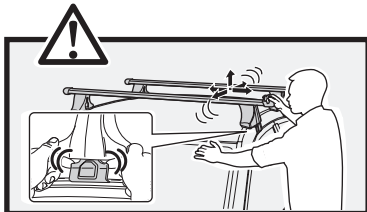
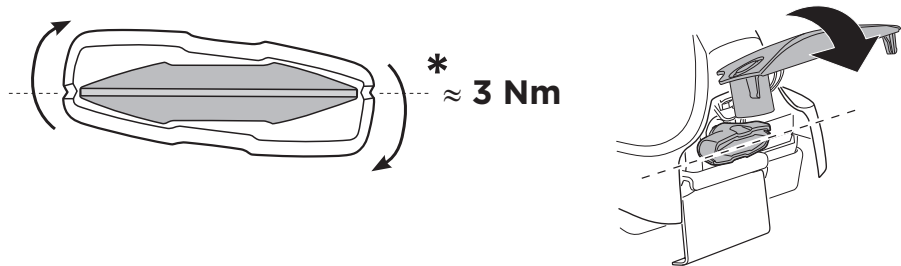
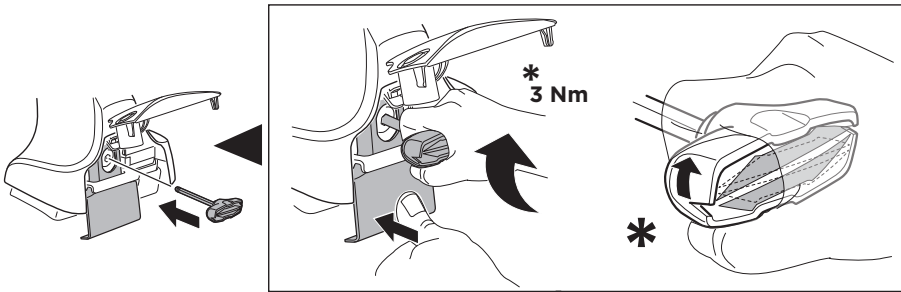

7

VOLKSWAGEN Golf V, 3-dr Hatchback, 04-07

VOLKSWAGEN Golf V, 5-dr Hatchback, 04-07

