

Kit 3123

FORD Transit Custom, 4-dr Van, 13-

This Kit is only for vehicles with fixpoint mounting.

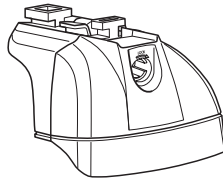

460R
753

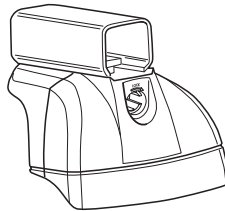
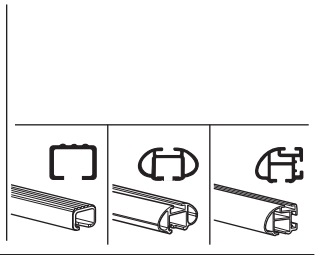

460

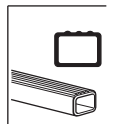

THULE[®]
SWEDEN

ISO 11154-E

6 kg / 13 lbs + xx kg / xx lbs = **Max. 100 kg**
Max. 220 lbs

9 kg / 20 lbs + xx kg / xx lbs = **Max. 150 kg**
Max. 330 lbs

Warning: Do not exceed weight limits. Arrows indicate load distribution on the roof rack.

THULE Kit XXXX
instructions
THULE

Warning: Read instructions before use.

Warning: Do not exceed 80 km/h (50 Mph) when carrying a load. The speedometer shows 80 km/h (50 Mph) and 130 km/h (80 Mph).

A: Clean the roof surface with a brush and bucket.
B: Wipe the roof surface with a cloth.
C: Position the rack on the roof.

Kit

- 50864 x 8
- 50784 x 8
- 30147 x 8
- 51342 x 4
- 50273 x 1
- 50229 6 mm x 1
- 178 x 2
- 179 x 2
- 30 x 4

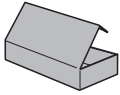

753

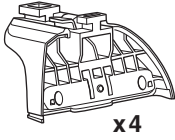

x4



x4



x4



x8



x1



x4



x1

460R

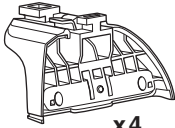

x4



x4



x4



x8



x1



x4

460

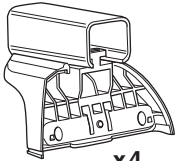

x4



x4



x4



x8



x1



x4

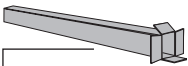

x2



x1

17 mm



x2

23 mm



x2

23 mm



x2



x2

17 mm



x2

23 mm

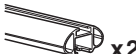

x2



x2



x2



x4



x4



x4



x2

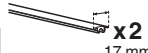

x2

17 mm

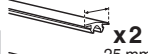

x2

25 mm



x2



x2

x2



x4

x4



x1

5 mm

1

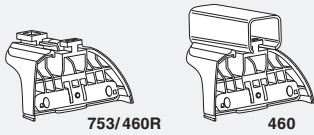

+

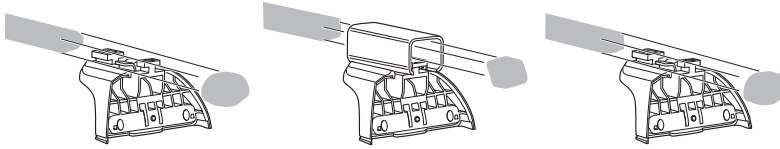

x4

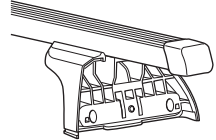
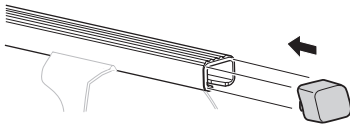

x4

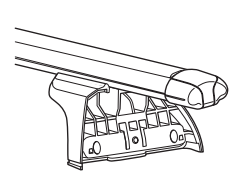
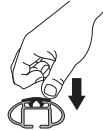
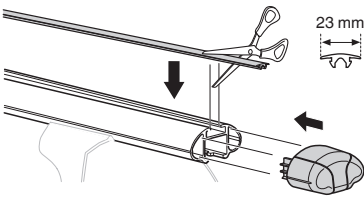

x4

x4

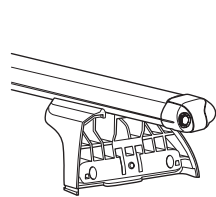
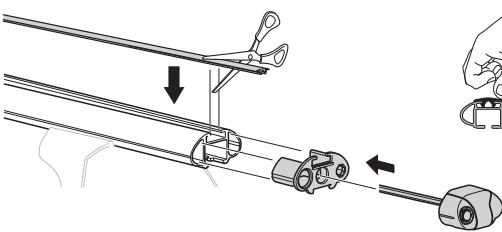

x4

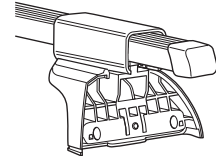
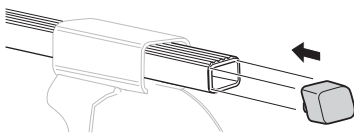

x2

x2

x4

x4

x1
5 mm

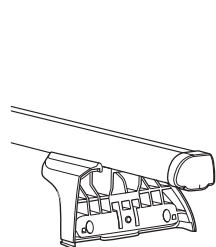
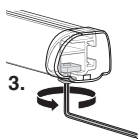
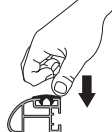
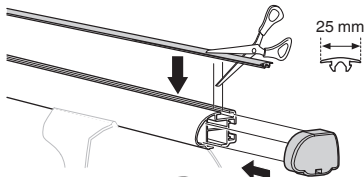

2

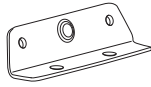

30 x 4

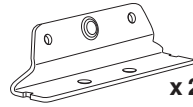

x 2

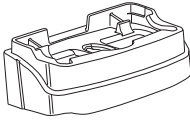

178 x 2

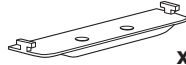

x 2

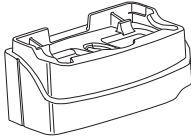

179 x 2



x 1

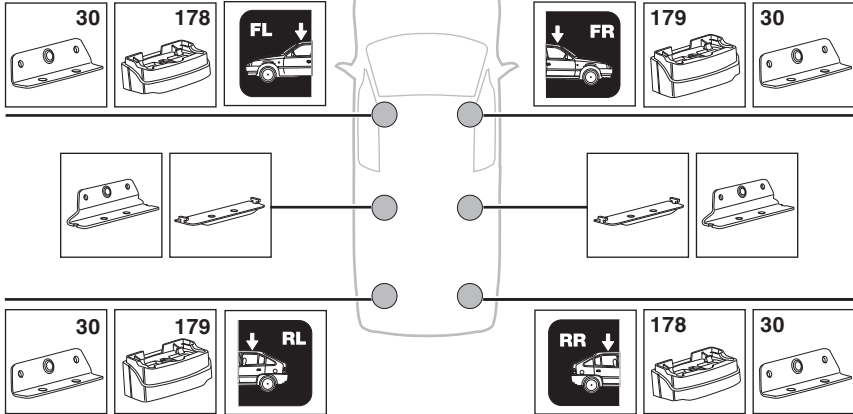

3

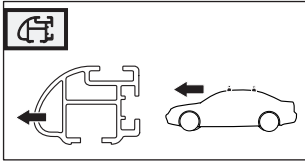

16 mm  x8 (x12)

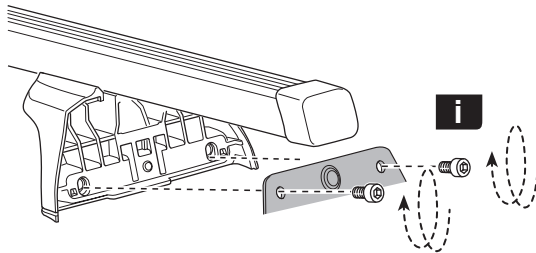
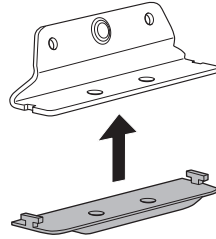
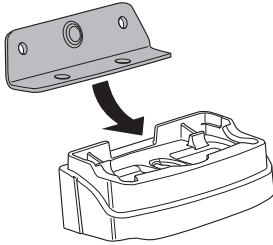

i

GB Only a few turns
D Nur wenige Umdrehungen
F Quelques tours uniquement
NL Slechts enkele slagen
I Solo qualche giro
E Sólo algunas vueltas
PT Noções básicas
S Endast några varv
FIN Vain muutama kierros

EST Ainult mõni pööre
LAT Tikai dažī apgriezieni
LIT Tik keli pasukimai
PL Wystarczy kilka obrotów
RU Достаточно нескольких оборотов
CZ Pouze několik otáček
SK Len niekoľko otáčok
SLO Le nekaj obratov

HR Samo nekoliko okreta
HU Csak néhány fordítás
GR Μόνο μερικές στροφές
TR Yalnız birkaç kez çevirm
中文 只有几个转向
한국어 두 세번만
日本語 数回転のみ
ไทย หมุนเพียงไม่กี่รอบ

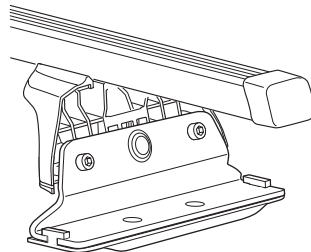
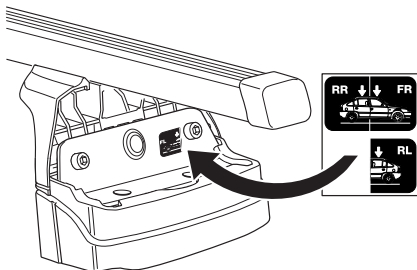

4

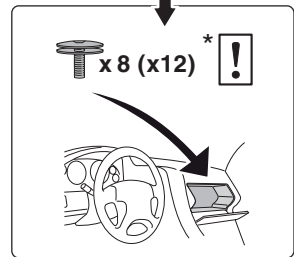
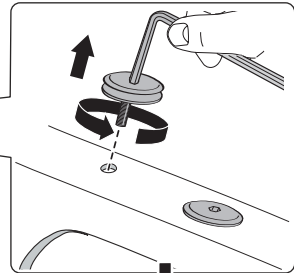
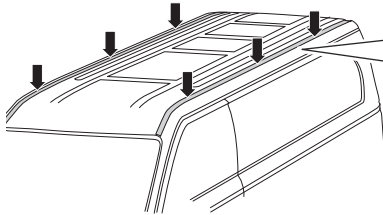
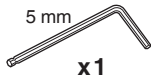

5

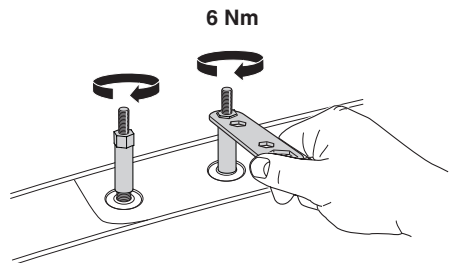
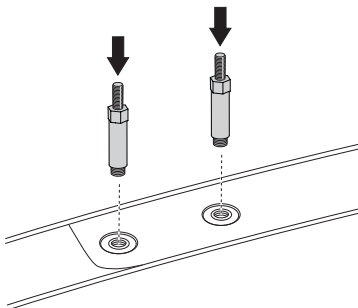
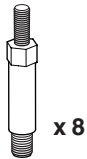
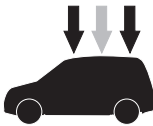

6

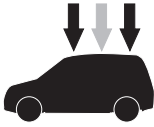

 x 8
 x 8

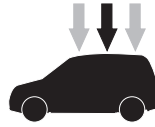

 x 4

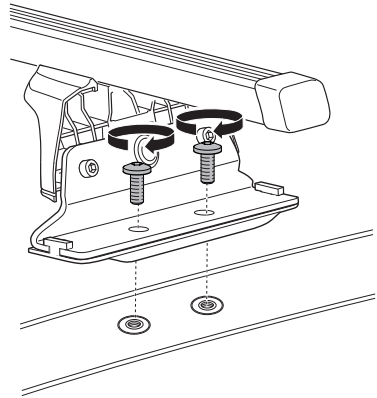
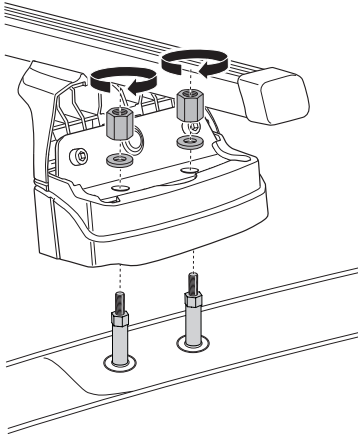
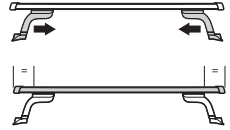
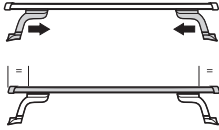

7

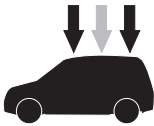

 x 1

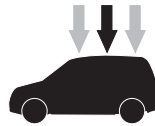

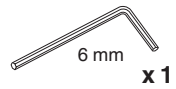
 6 mm x 1

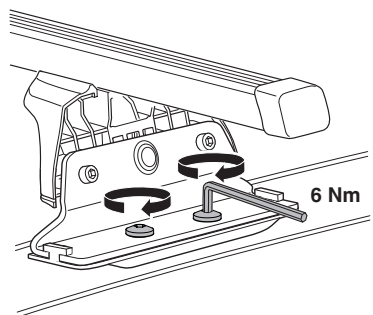
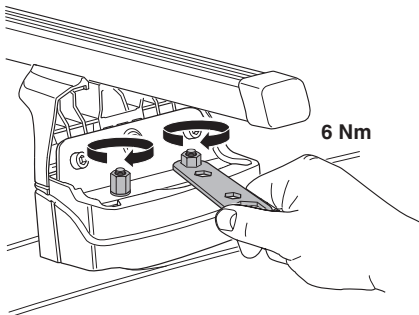

8

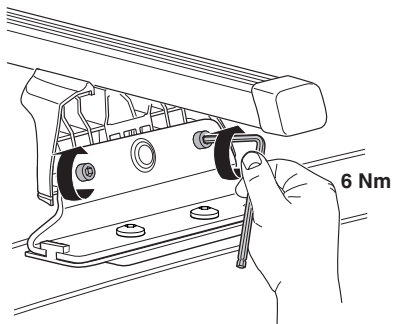
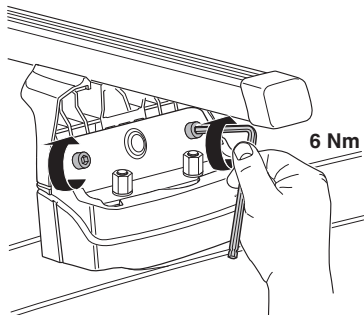
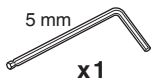
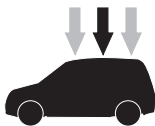
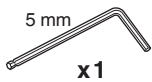
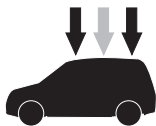

9



x4



x4



x1



x4



x4

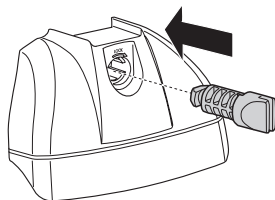
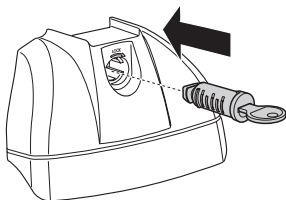

10

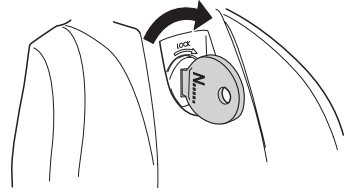
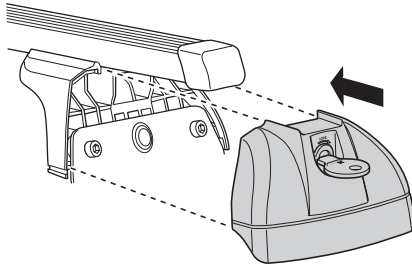

753

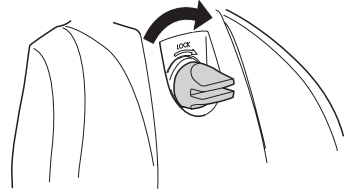
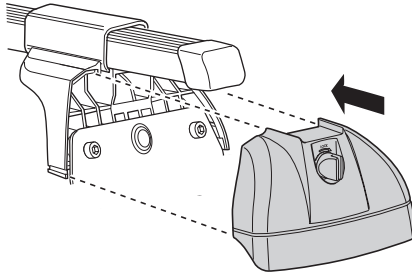

460/460R

11

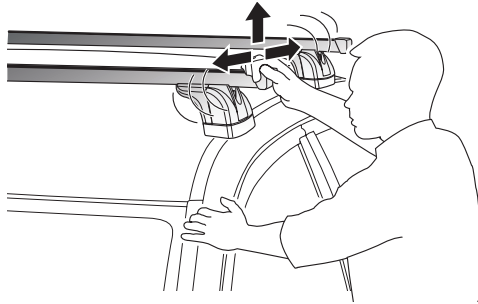

12

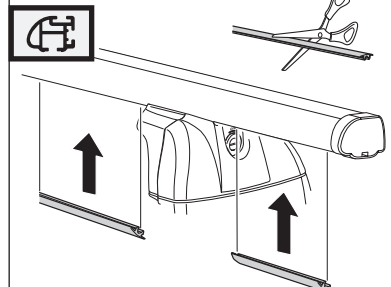
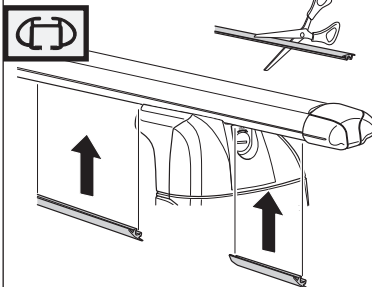
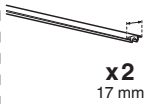

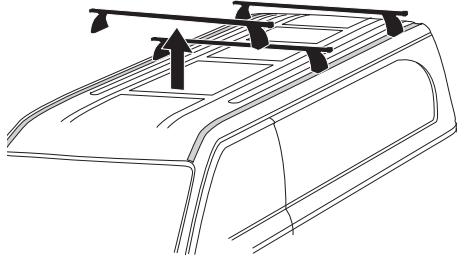

A

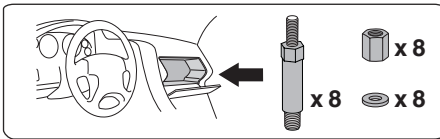
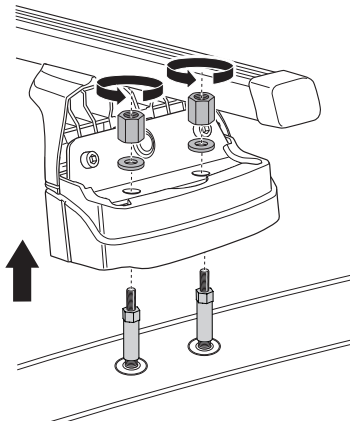

A

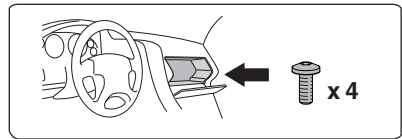
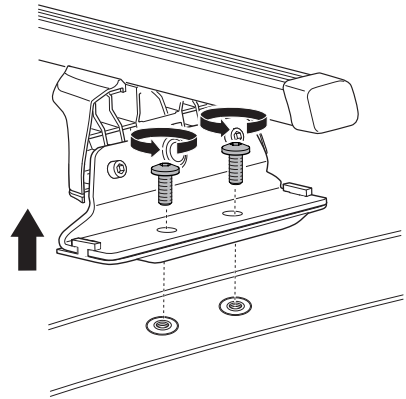



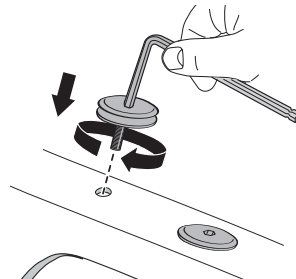
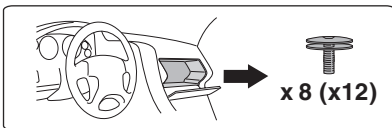

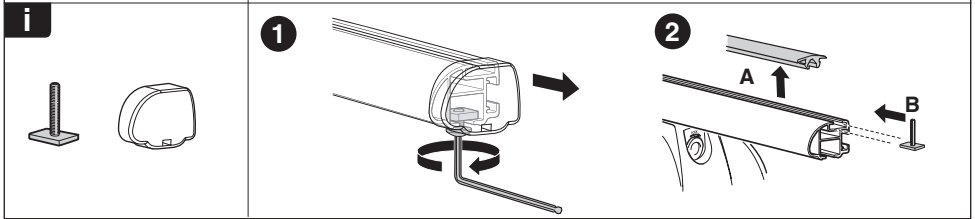
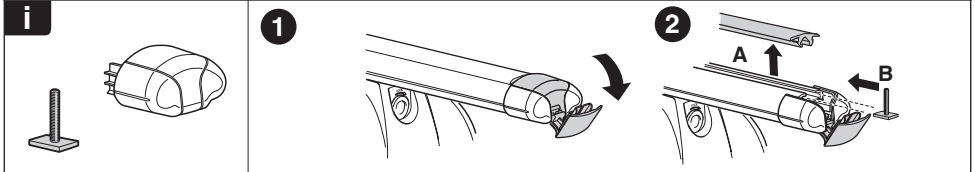
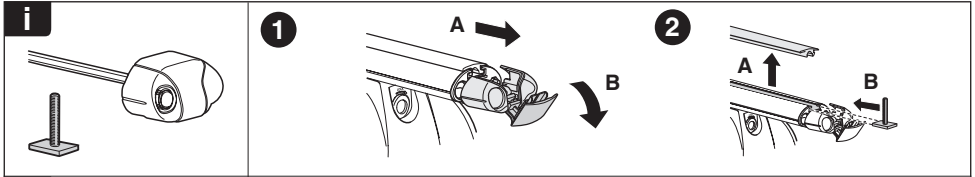
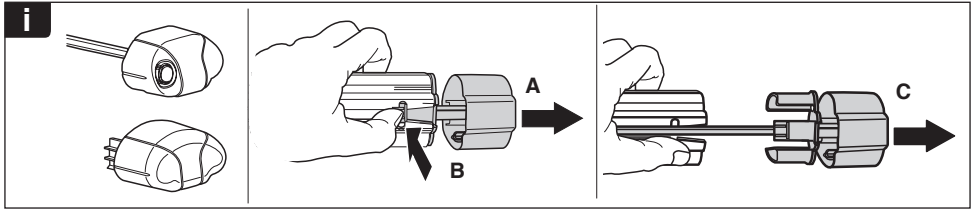

B

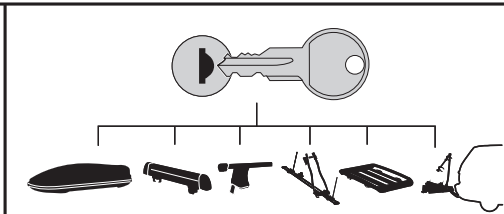



THULE
SWEDEN
**ONE
KEY
SYSTEM**



- 544**  (x4)
- 596**  (x6)
- 588**  (x8)
- NA 510**  (x10)
- EUR 452**  (x12)