

# Diagonal cutting nippers

461/1BI



## Profiles

---



## Standards



---

DIN ISO 5749

## Product features

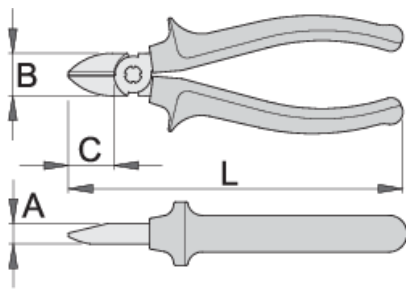
- material: premium plus carbon steel
- drop forged, entirely hardened and tempered
- cutting edges induction hardened
- head polished
- surface finish: chrome plated to standard ISO 1456:2009
- heavy duty double - component handles
- made according to standard ISO 5749



	L	B	A	C	
607883	140	19	9.5	18	169
607884	160	22.5	10	22	214

cutting capacity (10N=1kg)

	L	max 1600 N/mm <sup>2</sup> Ø↑	max 650 N/mm <sup>2</sup> Ø↑
607883	140	1,6	2,0
607884	160	1,6	2,5

\* Images of products are symbolic. All dimensions are in mm, and weight in grams. All listed dimensions may vary in tolerance.

Usage (pictures)

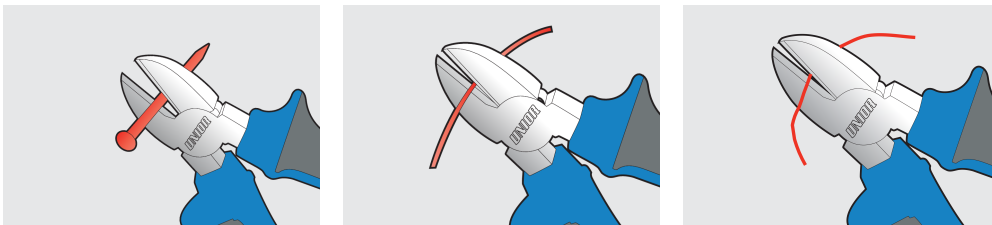

## Frequently asked questions

**What does it mean that the pliers are quenched and tempered and the head parts/teeth of the pliers are inductively hardened?**

It means that the pliers are thermally processed by quenching and tempering their entire surface to a hardness of about 45HRc, while head parts are additionally inductively hardened to a hardness of at least 60HRc.

**What is meant by the statement that pliers are made in accordance with the stated ISO standard?**

It means that the pliers are in accordance with the international standard in terms of dimensions, strength and structure, and compliance is determined by prescribed tests.